

# 回転形モータ駆動ボリューム

## Rotary Motor-driven Potentiometers

豊富なバラエティで各種機器をリモートコントロール。  
**Available in variety for remote control of various equipment.**

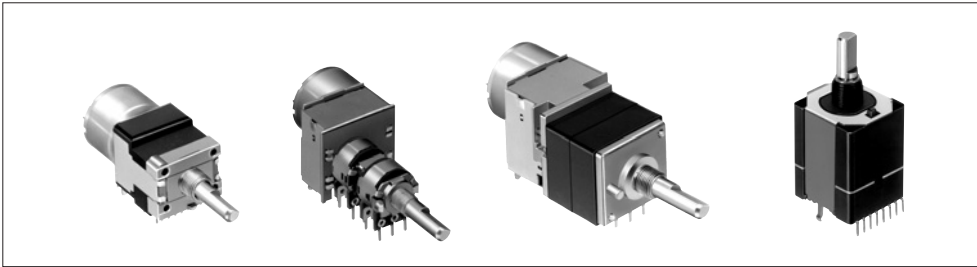

### ■ 特長

- オーディオ各種機器のボリュームを、リモートコントロール。
- モータ駆動および手動操作可能。
- 小形DCモータを内蔵し、300°/1秒の高速追従性で軸の回転動作が可能。(RK25T)
- マニュアル操作時は好操作フィーリングを実現。(RK25T)
- サーボ用トラック+タッチセンス用に、オーディオ用トラックの組み合わせも対応可能。(RK25T)

### ■ 用途

- アンプ、CDプレーヤ、ラジカセなどの音量コントロール用ボリューム
- プロオーディオ機器(ミキシングコンソール、ギターアンプなど)の各種コントロール。(RK25T)

### ■ Features

- Potentiometers for various audio products can be remote-controlled.
- Permits motor driving and manual operation.
- The small built-in DC motor enables axis rotation with high-speed follow-up of 300°/1 second. (RK25T)
- Good operational feel available when operated manually. (RK25T)
- For servo track + touch sensitivity applications, audio track combination is also available. (RK25T)

### ■ Applications

- For volume control in amplifiers, CD players, radio-cassettes, etc.
- Various controls for professional audio equipment such as mixing consoles and guitar amplifiers. (RK25T)

### ■ 主な仕様 Typical Specifications

項目 Item	仕様 Specification
全抵抗値許容差 Total resistance tolerance	±20%
最高使用電圧 Maximum operating voltage	50V AC
全回転角度 Total rotational angle	300±5°
回転トルク Rotational torque	15 to 45 mN·m
動作寿命 Operating life	15,000cycles
使用温度範囲 Operating temperature angle	-10°C to +70°C
モータ印加電圧 Motor voltage (V DC)	4 to 6 (Standard:4.5)
ボリューム回転速度 Potentiometer rotational speed (sec/300°)	12±3 (4.5V DC)
動作最大電流値 max. operating current (mA)	回転時 At rotation100 端末スリップ時 At end slip150 (4.5V DC)

## Rotary Motor-driven Potentiometers

## ■ 標準製品一覧 (ご推奨製品) Standard Products List (Recommended Products)

タイプ Type	モデル Model	抵抗素子数 Number of resistor elements	操作部形状 Shaft-types	操作部長さ Length of the shaft (mm)	全抵抗値 Total Resistance (Ω)	抵抗変化特性 Resistance taper	照光機能 Illumination function	モータプリント端子 Motor print terminal	製品番号 Products No.	最小梱包単位(個) Minimum packing unit (pcs.)	図番 Drawing No.	
16mm size	RK1681□MG0	Dual-unit	Flat	20	100k	15A	Without	With	RK16812MG0AF	200	1	
		Quad-unit		25		3B		Without	Without		RK16814MG02Z	2
		6-gangsd-unit						With	With		RK16816MGA04	3
	RK1681□MGL	Dual-unit		20	50k	Without	With (Red)	Without	RK16812MGL2K		4	
	RK1631□MC0	Dual-unit		20	100k		Without	With	With		RK16312MC05U	5
		Quad-unit			50k	Without	Without	Without	RK16314MC01A		6	
	RK16312MCL	Dual-unit		25	20k	15A	With (Red)	With	RK16312MCL1N		150	7
20			50k	Without	Without	Without	Without	RK18112MC00D	8			
18mm size	RK18112MC0	Dual-unit	20		50k	Without	With	RK25T11M0000	210	9		
25mm size	RK25T	Single-unit	20	10k	1B		Without	With	RK27112MC030	150	10	
27mm size	RK27112MC0	Dual-unit	25	100k	15A	Without	Without					

注記  
Notes

- 上記の標準製品以外にも、対応できる製品を取りそろえております。P.52の「製品バラエティ」をご参照ください。詳しくは、当社営業へお問合わせ願います。
  - その他、詳細仕様についてはP.56をご参照ください。
- More conforming products are available other than the above standard products. See “Products Varieties” on Page 52. For inquiries, contact our Sales Department.
  - For other detailed specification, Please see P.56.

Rotary Potentiometers	Metal Shaft	Insulated Shaft	Operating Knob
	General-use	Slide Potentiometers	Mixer
Trimner Potentiometers	Insertion-type	Chip-type	
	Variable Resistor Type	Multi Control Devices	Switch Type
			Position Sensors

# 回転形モータ駆動ボリューム製品バラエティ

## Rotary Motor-driven Potentiometers Products Varieties

標準製品(ご推奨製品)に加えて、下記仕様にも対応いたします。

In addition to the standard products (recommended products), the following specifications are supported too.

### ■ モータ部主な仕様 Basic Motor Specifications

タイプ Type	連数 Number of unit	製品名 Model	モータ仕様 Motor type		モータ 印加電圧 Motor voltage (V DC)	ボリューム 回転速度 Potentiometer rotational speed (sec/300°)	動作最大 電流値 max. operating current (mA)
			シールドケース Sealed case	モータ プリント端子 Motor printed terminal			
16mm size	Single-shaft, dual-unit	RK16812MG	対応可 Available	対応可 Available	4 to 6 (Standard:4.5)	12±3 (4.5V DC)	回転時 At rotation 100 端末スリップ時 At end slip 150 (4.5V DC)
	Single-shaft, quad.-unit	RK16814MG					
	Single-shaft, 5-ganged-unit	RK16815MG					
	Single-shaft, 6-ganged-unit	RK16816MG					
16mm size illuminated, through- shaft type	Single-shaft, dual-unit	RK16812MGL					
	Single-shaft, quad.-unit	RK16814MGL					
	Single-shaft, 5-ganged-unit	RK16815MGL					
16mm size	Single-shaft, dual-unit	RK16312MC					
	Single-shaft, quad.-unit	RK16314MC					
16mm size illuminated, front- mounting type	Single-shaft, dual-unit	RK16312MCL					
	Single-shaft, quad.-unit	RK16314MCL					
18mm size	Single-shaft, dual-unit	RK18112MC					
	Single-shaft, quad.-unit	RK18114MC					
27mm size	Single-shaft, dual-unit	RK27112MC					
	Single-shaft, quad.-unit	RK27114MC					
25mm size	Single-shaft, single-unit	RK25T11M0	対応不可 Not available	With	5	1	2000

### ■ 全抵抗値種類 Total Resistance Variety

全抵抗値[kΩ] Total Resistance[kΩ]	10	20	50	100	200	250

### ■ 抵抗変化特性 Resistance Taper

抵抗変化特性 Resistance Taper	15A・3B

### ■ 16形(RK168シリーズ)操作部の種類

#### 16mm Size (RK168 Series) Shaft Variety

Unit : mm

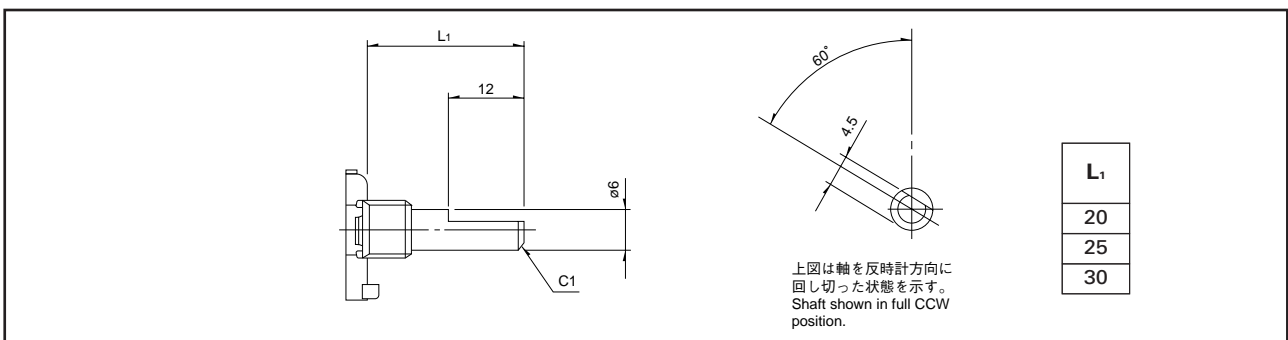



# Rotary Motor-driven Potentiometers

## 外形図 Dimensions

Unit : mm

No.	製品名 Model	形状 Style	プリント基板取付穴寸法図 P.C.Board mounting hole dimensions
5	<b>16mm size</b> Single-shaft, dual-unit RK16312MC	<p>Shaft shown in full CCW position</p>	<p>Mounting hole detail viewd fr om mounting side</p>
6	<b>16mm size</b> Single-shaft, quad.-unit RK16314MC	<p>Shaft shown in full CCW position</p>	<p>Mounting hole detail viewd fr om mounting side</p>
7	<b>16mm size</b> Single-shaft, dual-unit 照光式前面タイプ Illuminated, front-mounting type RK16312MCL	<p>Shaft shown in full CCW position</p>	<p>Mounting hole detail viewd fr om mounting side</p>
8	<b>18mm size</b> Single-shaft, dual-unit RK18112MC	<p>Shaft shown in full CCW position</p>	<p>Mounting hole detail viewd fr om mounting side</p>
9	<b>25mm size</b> Single-shaft, Single-unit RK25T11M0	<p>軸は反時計方向に回しきった状態を示す。 Shaft shown in full CCW position.</p> <p>取付面 Mounting surface</p> <p>サーボ用・オーディオ用トラック Servo&amp;Audio track</p> <p>サーボ用トラック Servo track</p>	<p>取付穴寸法図 Mounting hole detail Viewed from mounting side 板厚 T=1.6</p> <p>パターン配線禁止範囲 Prohibition of pattern wiring</p>
10	<b>27mm size</b> Single-shaft, dual-unit RK27112MC	<p>Shaft shown in full CCW position</p>	<p>Mounting hole detail viewd fr om mounting side</p>

Rotary Motor-driven Potentiometers

Rotary Potentiometers	Metal Shaft
	Insulated Shaft
	Operating Knob

Slide Potentiometers	General-use
	Mixer

Trimmer Potentiometers	Insertion-type
	Chip-type

Multi Control Devices	Variable Resistor Type
	Switch Type

Position Sensors
------------------

■ 16形 (RK168シリーズ) 軸受およびシャシ止標準寸法

16 Size (RK168 Series) Standard Dimensions of Bushing and Fixing Lug

Unit : mm

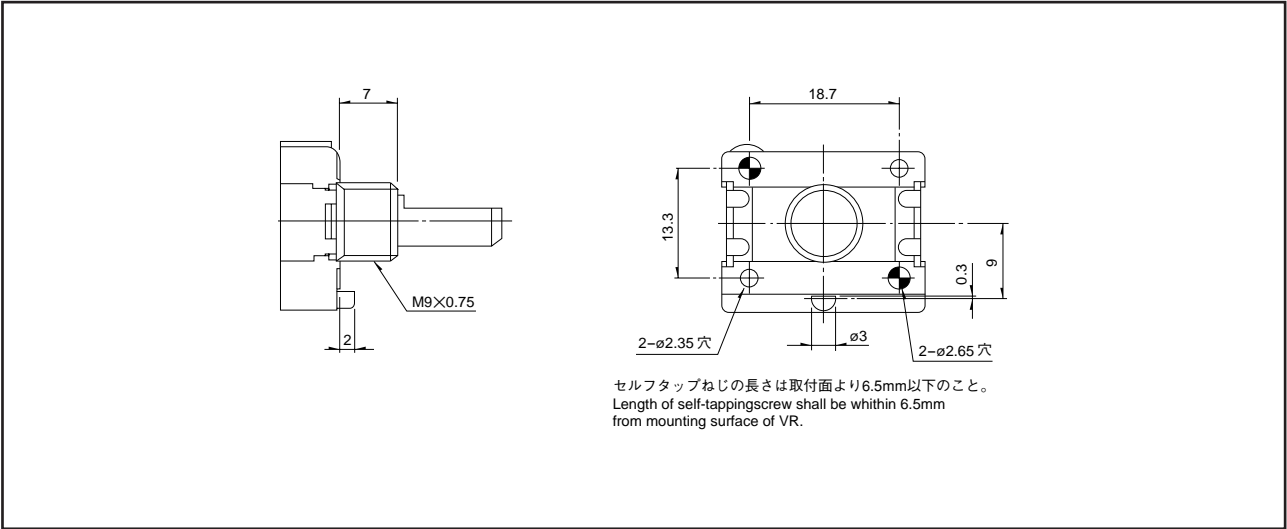

■ モータプリント端子形状 Style of Printed Terminal for Motor

Unit : mm

